

HALSMUTTER - EDELSTAHL

09/12-14 vers.2



ARTIKELNUMMER

| | |
|----------|----------|
| Ø12/Ø16 | U1901402 |
| Ø20/Ø25 | U1902502 |
| Ø32 | U1903202 |
| Ø40 | U1904002 |
| Ø50/Ø63 | U1905002 |
| Ø80/Ø100 | U1909002 |
| Ø125 | U1912502 |

Halsmutter, Edelstahl AISI 304 für Zylinder Ø12 - Ø125

MASSBLATT (MM)

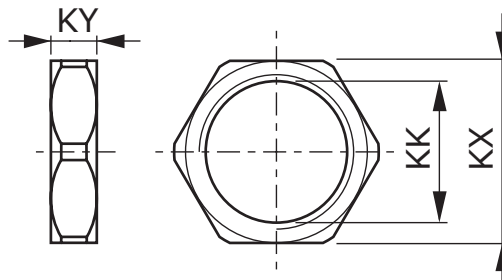

| Zyl.Ø | KK | KX | KY | kg |
|--------|---------|----|----|-------|
| 12/16 | M16x1,5 | 24 | 8 | 0,018 |
| 20/25 | M22x1,5 | 27 | 8 | 0,018 |
| 32 | M30x1,5 | 36 | 8 | 0,030 |
| 40 | M36x1,5 | 46 | 8 | 0,055 |
| 50/63 | M42x1,5 | 55 | 8 | 0,110 |
| 80/100 | M55x1,5 | 70 | 12 | 0,180 |
| 125 | M60x2,0 | 90 | 12 | 0,500 |

* = DIN/ISO Normmaß